

Auto Welding Types • WCME/WCRME/WCMT/WCRMT

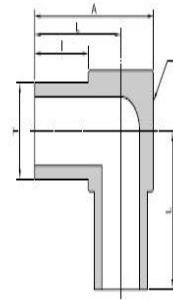

Micro Elbow WCME



Part No.	T		Wall Thickness	A	L	F Flat		L	Pressure Rating (psi)
	in	mm				in	mm		
WCME-02	1/8	3.17	0.71	14.2	6.4	5/16	7.94	10.4	8500
WCME-04	1/4	6.35	0.89	14.2	6.4	5/16	7.94	10.4	5100
WCME-06	3/8	9.52	0.89	17.5	6.4	7/16	11.11	11.9	3300
WCME-08	1/2	12.70	1.24	20.6	6.4	9/16	14.29	13.5	3700