

*Micro Tribow*  
**WCTB**

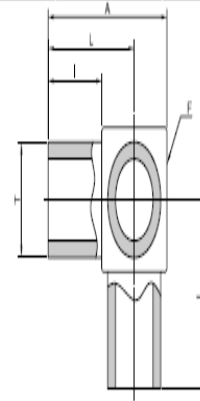

Part No.	T		Wall Thickness	A	l	F Flat		L	Pressure Rating (psi)
	in	mm				in	mm		
WCTB-04	1/4	6.35	0.89	14.2	6.4	5/16	7.94	10.4	5100
WCTB-06	3/8	9.52	0.89	17.5	6.4	7/16	11.11	11.9	3300
WCTB-08	1/2	12.70	1.24	20.6	6.4	9/16	14.28	13.5	3700