

Tube Fittings • UMC/UME

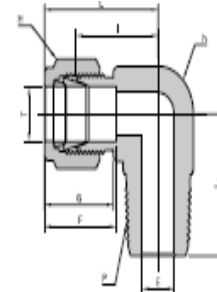

Male Elbow
UME



Connects Fractional Tube to Female NPT Thread

Part No.	Tube O.D. T		P (NPT)	E Min	h		H		F	G	l	L	L ₁
	in	mm			in	mm	in	mm					
20UME-20N	1-1/4	31.75	1-1/4	27	1-11/16	42.86	1-7/8	47.63	41.1	38.8	44.4	66.5	47.7
24UME-24N	1-1/2	38.10	1-1/2	34	2	50.80	2-1/4	57.15	50.0	45.2	50.8	77.9	60.4
32UME-32N	2	50.80	2	46	2-3/4	69.85	3	76.20	62.7	63.7	69.8	107.1	70.6

Male ISO Tapered Threads are available for all fractional UME. Add "R" as a suffix instead of "N".

Connects Metric Tube to Female ISO Tapered Thread

Part No.	Tube O.D. T(mm)	P (PT)	E Min	h (mm)	H (mm)	F	G	l	L	L ₁
M30UME-20R	30.00	1-1/4	26	46.04	49.21	39.6	39.2	48.3	69.9	53.1
M32UME-20R	32.00	1-1/4	27	46.04	49.21	42.0	41.6	49.3	72.3	53.1
M38UME-32R	38.00	1-1/2	33	55.56	60.32	49.4	47.9	56.4	84.0	60.4

Male NPT Threads are available for all metric UME. Add "N" as a suffix instead of "R".

Note : Dimensions are reference only, subject to change without prior notice. F, G and L are typical finger tight.